



PASAMANOS Ø30 INOX. BRILLO L=700

HANDRAIL POLISHED STAINLESS STEEL Ø30 L=700

MAIN COURANTE INOX. POLIE Ø30 L=700

CODIGO

200228



Suministrado con casquillos de montaje
/ Supplied with mounting bushes /
Fourni avec douilles de montage

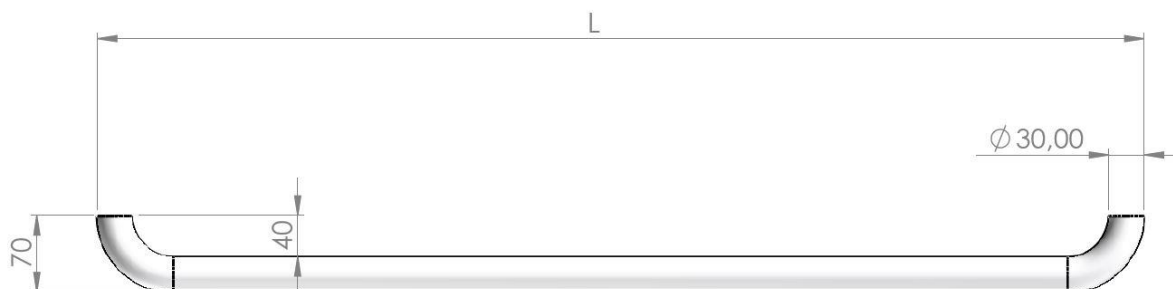

DATOS TECNICOS

TECHNICAL DATA

DONNÉES TECHNIQUES

- MATERIAL:** Acero inoxidable pulido/Polished stainless steel/Acier inoxydable polie

L (mm)	CODE
300	200223
350	200647
450	200224
550	200939
600	200226
650	200227
700	200228
800	200229
900	200230
920	200710
950	200231

L (mm)	CODE
1000	200215
1100	200216
1150	200217
1200	200218
1250	200219
1300	200221
1350	200222
1500	200627